



# ANGLESEA MINE REHABILITATION & CLOSURE PLAN

---

FOR CONSULTATION  
JUNE 2017





## ANGLESEA MINE REHABILITATION & CLOSURE PLAN

Following the permanent shut down of the Anglesea Power Station and Mine in August 2015, Alcoa has continued to actively engage with the community and key stakeholders about the future of its freehold and leasehold areas.

Alcoa has now prepared a Mine Rehabilitation & Closure Plan to meet its commitment to the community and regulatory obligations, and is seeking feedback ahead of the Plan's submission to the regulator, Earth Resources Regulation of the State Government's Department of Economic Development, Jobs, Transport and Resources.

The Plan, as illustrated, details the rehabilitation and the future land form of the area disturbed by mining. The area is predominantly leased land.

Features include a large water body, extensive rehabilitated areas, and proposed areas and access for potential future alternative uses.

The Plan is underpinned by key geotechnical, hydrological and vegetation technical studies undertaken by experienced consultants, with these being independently peer reviewed where appropriate.

The Plan also considers the five guiding principles developed during broad community consultation in 2016, and reflective of the community's aspirations for the site:

- Provides a safe and stable landform for future uses
- Values and complements the natural environment
- Supports a diverse range of future uses and outcomes
- Honours the various cultural and heritage values of the area
- Complements the future of the Anglesea Region

The implementation of the Plan is described as six 'key moves' and it is envisaged rehabilitation will be managed by Alcoa over the next ten years.

# KEY MOVES:

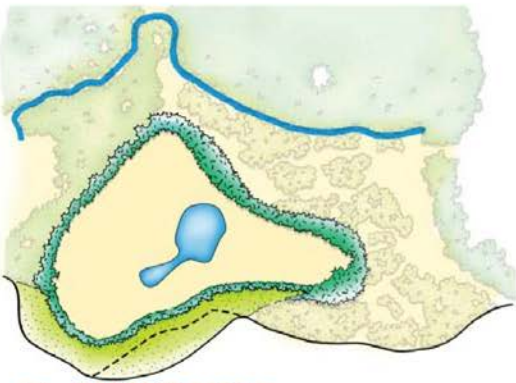

# 1

## SAFE AND STABLE

- Remove Coalmine Rd
- Perform earthworks
- Establish erosion control

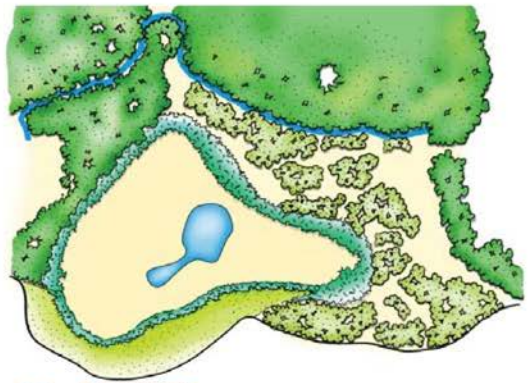

# 2

## PRESERVE

- Minimise impact on Anglesea Heath
- Preserve historical rehabilitation

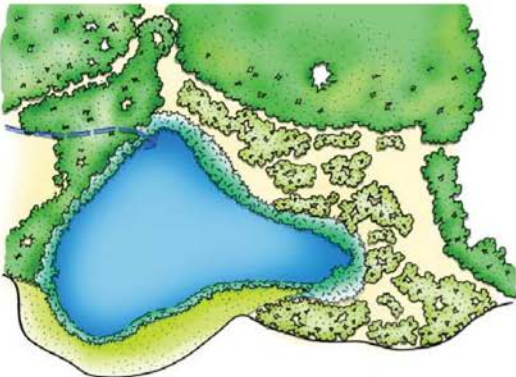

# 3

## FILL

- Redivert Salt Creek
- Active water quality management
- Fill above Anglesea River level

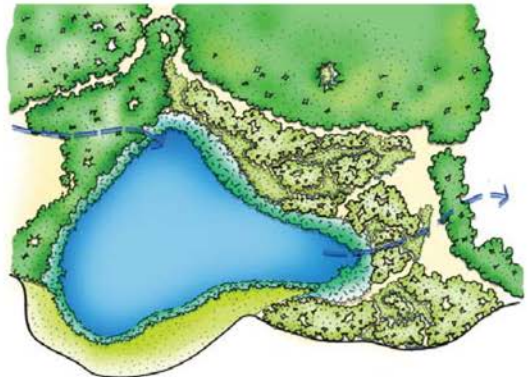

# 4

## CONSOLIDATE

- Infill historical rehabilitation
- Connect water body to Anglesea River

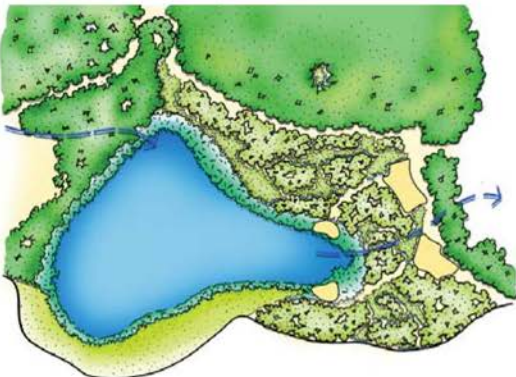

# 5

## PREPARE

- Remove existing infrastructure
- Prepare proposed areas for future alternative uses

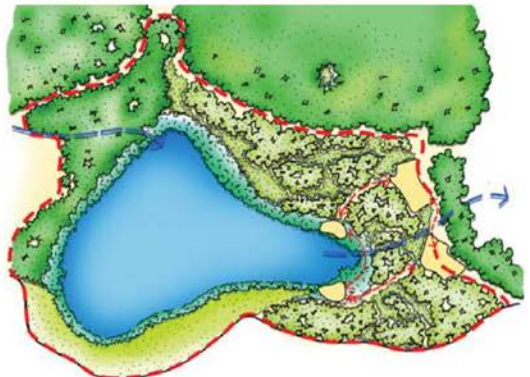

# 6

## HAND BACK

- Regulator approval and handover
- Provide access to proposed areas for alternative uses



## **ALCOA WANTS TO HEAR YOUR VIEWS**

As part of Alcoa's ongoing commitment to community consultation, the community is invited to provide feedback on the Mine Rehabilitation & Closure Plan.

### **View the plan and share your views at a Community 'Drop In' Session**

#### **Dates**

Sunday 11 June, 10am to 1pm  
Wednesday 14 June, 4pm to 7pm  
Monday 19 June, 4pm to 7pm

#### **Venue**

Anglesea Senior Citizens Club, McMillan Street, Anglesea

### **Download the Plan and complete the survey**

[engage-anglesea.alcoa.com.au](http://engage-anglesea.alcoa.com.au)

### **Send Alcoa your feedback**

[angleseaps@alcoa.com.au](mailto:angleseaps@alcoa.com.au)  
Alcoa of Australia, Camp Road, Anglesea VIC 3230

**The consultation period concludes on Sunday 25 June.**